

REGISTRATION OF CHASSIS PROTECTOR

Manufacturer	Gillard Racing Karts Ltd
Material	HDPE
Method of fixation	2x M6 screws per side, 3x M6 screws front
Valid from	23 May 2013
Number of pages	3

This Registration Form reproduces descriptions, illustrations and dimensions of the chassis protector at the moment of registration. This document may be supplemented by official amendment.



Photo of Chassis Protector

SIGNATURE AND STAMP OF THE MSA



Date: **23 May 2013**

Signed by: **John Ryan**

Position: **MSA Technical Executive**

Any reproduction must be authorised by the MSA

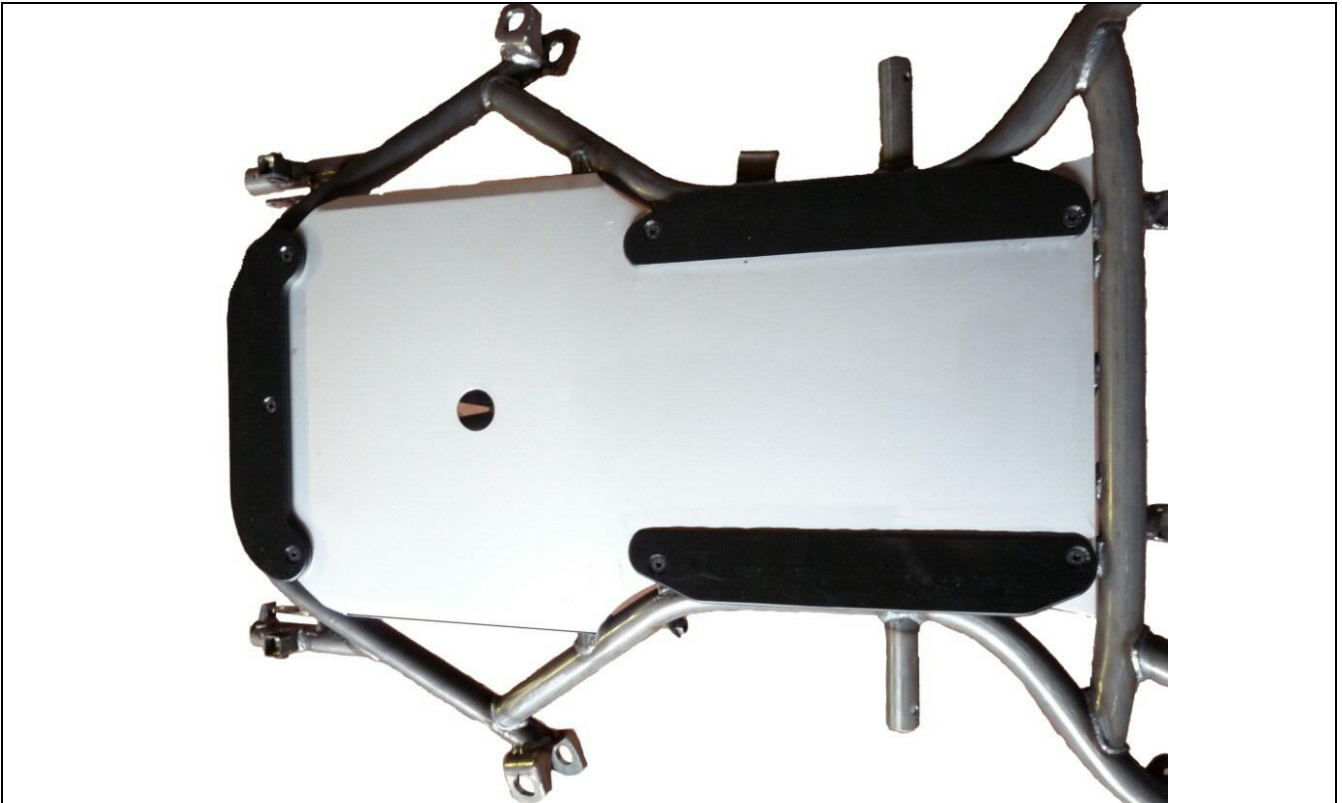
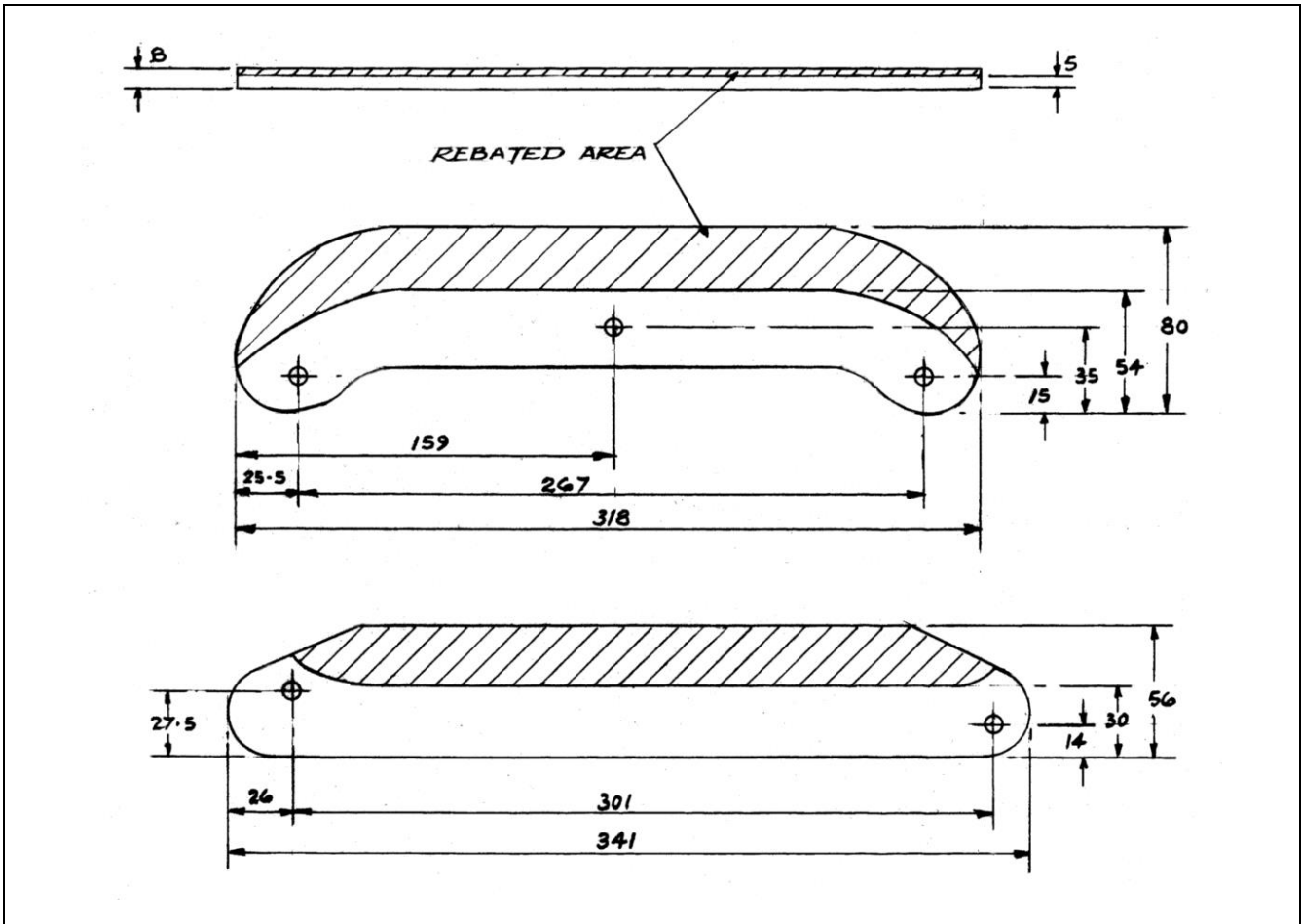

Photo of Chassis Protector Attached to Kart



Image of Identification Marking



Drawing of the Chassis Protector (including dimensions)

COMPLIMENTARY INFORMATION

This set is designed primarily for Gillard TG14 model, may fit other models subject to drilling new holes in these protectors.

Installation instructions and fixings are provided in the set.