

## 2020 MOTORSPORT UK YEARBOOK ERRATA

Since the publication of the 2020 Yearbook, the following **corrections** and **changes to regulations** have been made. The online editions are up-to-date.

### Who's Who at Motorsport UK

Office Services Manager:  
• *Sheila Barter*

HR & Facilities Manager:  
• *Sheila Barter*

### Section B Nomenclature and Definitions

**Endurance Kart Event.** A Kart Race of a minimum of 60 minutes duration, where the need to refuel and/or make Drivers stops, or changes, is an integral part of the race. Drivers must have reached their 16<sup>th</sup> birthday. A group of licensed drivers may be referred to collectively by their team name without the requirement to hold an Entrants Licence.

There are two types of Endurance Kart events and these require different licence grades, namely:

- (a) For engines which do not exceed 15hp in total per kart drivers must hold a minimum of a Kart Clubman Licence.
- (b) For engines exceeding 15hp in total per kart drivers must hold a minimum of a Kart National 'B' (Novice) licence.

**Kart Clubman Event.** A Kart Clubman Event is a Kart Race Event run primarily as entry level Karting. Engines may not exceed 15hp for Seniors or 10hp for Juniors, in total per Kart. Competitors must hold a Kart Clubman's Licence, as a minimum.

### Section C Judicial

**6.1.1.** Any Entrant or Competitor shall have the Right of Appeal to the Stewards of the Meeting against any penalty or decision given by the Clerk of the Course or another Official of the Meeting except for cases where these Regulations specify that no right of appeal exists (2.1.6, 2.3.1, 2.3.2, 2.3.4, 2.6.2, 6.1.1, U21)

### Section D Organisers

**3.1.** All events at National 'B' or higher status must be inscribed on the Motorsport UK Fixture List.

**Endurance Kart Event.** A Kart Race of a minimum of 60 minutes duration, where the need to refuel and/or make Drivers stops, or changes, is an integral part of the race. Drivers must have reached their 16th birthday. A group of licensed drivers may be referred to collectively by their team name without the requirement to hold an Entrants Licence.

There are two types of Endurance Kart events and these require different licence grades, namely:

- (a) For engines which do not exceed 15hp in total per kart drivers must hold a minimum of a Kart Clubman Licence.
- (b) For engines exceeding 15hp in total per kart drivers must hold a minimum of a Kart **Interclub** licence.

**Kart Clubman Event.** A Kart Clubman Event is a Kart Race Event run primarily as entry level Karting. Engines may not exceed **17hp** for Seniors or 10hp for Juniors, in total per Kart. Competitors must hold a Kart Clubman's Licence, as a minimum.

**6.1.1.** Any Entrant or Competitor shall have the Right of Appeal to the Stewards of the Meeting against any penalty or decision given by the Clerk of the Course or another Official of the Meeting except for cases where these Regulations specify that no right of appeal exists (2.1.6, 2.3.1, 2.3.2, 2.3.4, 2.6.2, ~~6.1.1~~, U21)

**3.1.** All events at **Interclub** or higher status must be inscribed on the Motorsport UK Fixture List.

**3.1.1.** Events at a lesser status than National 'B' must be listed on a Regional Association fixture list.

**3.1.1.** Events at a lesser status than **Interclub** must be listed on a Regional Association fixture list.

## Section J Vehicles

Section 'G'		HILLCLIMB AND SPRINT MAXIMUM AT ½ MAXIMUM RPM – RACING AND SPORTS LIBRE CARS AND CARS COMPLYING WITH S.12 AND S.13 ALL OTHER CATEGORIES
110	98	
108	96	

Section 'G'		HILLCLIMB AND SPRINT MAXIMUM AT ½ MAXIMUM RPM – RACING AND SPORTS LIBRE CARS AND CARS COMPLYING WITH <del>S.12</del> AND S.13 ALL OTHER CATEGORIES
110	98	
108	96	

## Section K Safety

**2.1.** All seat safety belts must be complete units sourced from a recognised manufacturer and fitted in accordance with the manufacturers' instructions, Motorsport UK recommendations or FIA requirements. (See Drawing Nos. 39, 40, 41, 42 and 44.)

Where the vehicle manufacturer's standard safety belts and associated fitments are not utilised, bolts must be of a minimum 7/16in UNF or M12 (grade 8.8).

**2.1.1. Three point.** One diagonal shoulder strap and one lap strap, with three anchorage points on the chassis/body shell or roll over bar of the vehicle on either side and to the rear of the driver's seat.

### Appendix 3

**3.2.3.** Minimum quantity of extinguishant:

- AFFF 2.4 litres
- FireSense 2.4 litres
- FX G-TEC 2.0 kg
- Viro3 2.0 kg
- Zero 360 2.0 kg
- Extreme 2.0 kg
- Powder 2.0 kg

## Section N Autocross and Rallycross

**5.1.4.** For National 'B' and above status Permitted Events only, for venues authorised by the issued Track licence to include Joker Laps, the Joker Lap may be used. Two Judges of Fact to be appointed to oversee its use.

**2.1.** All seat safety belts must be complete units sourced from a recognised manufacturer and fitted in accordance with the manufacturers' instructions, Motorsport UK recommendations or FIA requirements. (See Drawing Nos. 39, 40, 41, 42 and 44.)

Where the vehicle manufacturer's standard safety belts and associated fitments are not utilised, bolts must be of a minimum 7/16in UNF or M12 (grade 8.8) or, for an FIA homologated harness, as specified by the harness manufacturer.

**2.1.1. Three point.** Either one diagonal shoulder strap and one lap strap, or two merged shoulder straps and one lap strap bearing an ECE 'E' mark. With three anchorage points on the chassis/body shell or roll over bar of the vehicle on either side and to the rear of the driver's seat.

### Appendix 3

**3.2.3.** Minimum quantity of extinguishant:

- AFFF 2.4 litres
- FireSense 2.4 litres
- FX G-TEC 2.0 kg
- Viro3 2.0 kg
- Zero 360 2.0 kg
- **Novac 1230 2.0 kg**
- Extreme 2.0 kg
- Powder 2.0 kg

**5.1.4.** For **Interclub** and above status Permitted Events only, for venues authorised by the issued Track licence to include Joker Laps, the Joker Lap may be used. Two Judges of Fact to be appointed to oversee its use.

**6.13.6. Seats.** Be fitted with a driver's seat FIA Homologated, and mounted in accordance with K.2.2.

**6.13.6.1.** For national events, FIA homologated seats manufactured to FIA Standard 8855-1999 may be used for up to two years beyond the expiration of the original homologation label validity. FIA homologated seats manufactured to FIA Standard 8862-2009 may be used until 31st December of the year stated on the label. Strongly recommended for 2020, mandatory for 2021.

## Section P Cross Country Events

**14.1.1.** Competitors must be seeded in order of anticipated performance, with the first Competitor having the best performance potential, unless the MSA has given prior approval to the contrary.

## Section Q Circuit Racing

**3.4.9.** Once a Junior competitor reaches 16 years of age he/she is eligible to be issued a Race National 'B' licence. Upon issue of a Race National 'B' licence (unrestricted) and competition within Car Racing events the Driver will no longer be eligible to again be issued the Race National 'B' (Junior Formulae) licence nor to compete within the Junior Racing Formulae.

**3.5.4.** Once the driver reaches 16 years of age he is eligible to be issued an unrestricted Race National 'B' licence.

**11.3.** On any car driven by a person who has not received six car race signatures on his National 'B' Licence, there shall be on the back of the car a yellow square, 7in x 7in, with a black diagonal cross, with strokes 6in long and 1in wide.

## Section R Rallying

**48.8.** There are restrictions concerning the use of auxiliary lights which are detailed in the sporting regulations (27.1.13).

**6.13.6. Seats.** Be fitted with a driver's seat FIA Homologated, and mounted in accordance with K.2.2. Strongly recommended for 2020, mandatory for 2021.

**6.13.6.1.** For national events, FIA homologated seats manufactured to FIA Standard 8855-1999 may be used for up to two years beyond the expiration of the original homologation label validity. FIA homologated seats manufactured to FIA Standard 8862-2009 may be used until 31st December of the year stated on the label. Strongly recommended for 2020, mandatory for 2021.

**14.1.1.** Competitors must be seeded in order of anticipated performance, with the first Competitor having the best performance potential, unless Motorsport UK has given prior approval to the contrary.

**3.4.9.** Once a Junior competitor reaches 16 years of age he/she is eligible to be issued a Race Interclub licence. Upon issue of a Race Interclub licence (unrestricted) and competition within Car Racing events the Driver will no longer be eligible to again be issued the Race Interclub (Junior Formulae) licence nor to compete within the Junior Racing Formulae.

**3.5.4.** Once the driver reaches 16 years of age he is eligible to be issued an unrestricted Race Interclub licence.

**11.3.** On any car driven by a person who has not received six car race signatures on his Interclub Licence, there shall be on the back of the car a yellow square, 7in x 7in, with a black diagonal cross, with strokes 6in long and 1in wide.

**48.8.** There are restrictions concerning the use of auxiliary lights which are detailed in the sporting regulations (27.1.3).

## Section S Sprints, Hill Climbs and Drag Racing

**1.2.2.** At all National 'A' and above events, there should be at least one licensed Deputy/Assistant Clerks of the Course, in addition to the Clerk of the Course.

**17.2.4.1. Category of Driver:** There will be:

- (i) Club-Class for which a minimum of a Non-Race National 'B' licence is acceptable
- (ii) Pro-Class for which the driver must be in possession of a Race National 'B' licence, as a minimum.

Designation in regard to (ii) above is made by the Organising Committee and will be based upon a drivers previous motor sport experience, in the first instance, and then may be dependent upon other factors e.g. engine capacity, vehicle weight, lap times and previous Time Attack classification.

## Section T Trials

**4.1.10.** The same Driver must drive throughout any Competition.

## Section U Karting

**1.3.2.** For engines exceeding 15hp in total per kart, drivers must hold a minimum of a Kart National 'B' (Novice) licence.

**14.1.2.** A competitor will be considered as a 'Novice' and must use Novice number plates (17.27.4), for Long Circuits Q.11.3. applies, until he has obtained six kart race signatures from Motorsport UK Stewards. (Completion of the ARKS Course (H.8.3) will constitute one of the six signatures.) Three of these signatures may have been obtained at NatSKA meetings held under a Motorsport UK Permit. Thereafter he can continue to compete on a National 'B' (Novice) Licence, or can upgrade to a National 'B' Licence in accordance with H.19.2 but he will no longer be considered a novice.

**16.14.2.** For Karts in Long Circuit trim the brake pedal and all the parts operating the master cylinders must be made of steel and must be strong enough to withstand the forces applied.

**1.2.2.** At all National 'A' and above events, there should be at least one licensed Deputy/Assistant Clerks of the Course, in addition to the Clerk of the Course.

**17.2.4.1. Category of Driver:** There will be:

- (i) Club-Class for which a minimum of a **RS Interclub** licence is acceptable
- (ii) Pro-Class for which the driver must be in possession of a Race **Interclub** licence, as a minimum.

Designation in regard to (ii) above is made by the Organising Committee and will be based upon a drivers previous motor sport experience, in the first instance, and then may be dependent upon other factors e.g. engine capacity, vehicle weight, lap times and previous Time Attack classification.

**4.1.10.** *The same Driver must drive throughout any Competition.*

**1.3.2.** For engines exceeding 15hp in total per kart, drivers must hold a minimum of a Kart **Interclub** licence.

**14.1.2.** A competitor will be considered as a 'Novice' and must use Novice number plates (17.27.4), for Long Circuits Q.11.3. applies, until he has obtained six kart race signatures from Motorsport UK Stewards. (Completion of the ARKS Course (H.8.3) will constitute one of the six signatures.) Three of these signatures may have been obtained at NatSKA meetings held under a Motorsport UK Permit. Thereafter he can continue to compete on an **Interclub** Licence, or can upgrade to a **National** Licence in accordance with H.19.2 but he will no longer be considered a novice.

**16.14.2.** *Any device linking the accelerator and brake pedals, such that either of them may be prevented from being independently depressed partially or fully is prohibited.*

**16.14.3.** For Karts in Long Circuit trim the brake pedal and all the parts operating the master cylinders must be made of steel and must be strong enough to withstand the forces applied.

**21.2.** For National 'B' and above status short circuit Kart events: The Stewards of the Meeting are responsible for all judicial duties as well as at any Clubman meeting where specific authority has been given by Motorsport UK.

**21.2.** For Interclub and above status short circuit Kart events: The Stewards of the Meeting are responsible for all judicial duties as well as at any Clubman meeting where specific authority has been given by Motorsport UK.

## Section W Championships

**1.5.1.** All Kart Race Championship applications must be submitted by a recognised lead Club, no related discussion between Motorsport UK and any third party will be entered into without the agreement of the lead club. Only Clubs or Associations which have been recognised by Motorsport UK for more than two years are permitted to apply for a Championship Permit. Once a Club or Association has registered a Championship, or has been granted a Permit, it takes responsibility for controlling all Sporting, Technical, Financial and Calendar matters and must guarantee prize money as published.

**1.5.1.** All Kart Race Championship applications must be submitted by a recognised lead Club, no related discussion between Motorsport UK and any third party will be entered into without the agreement of the lead club. Only Clubs or Associations which are recognised by Motorsport UK for more than two years are permitted to apply for a Championship Permit and which may be granted at the sole discretion of Motorsport UK. Once a Club or Association has registered a Championship, or has been granted a Permit, it takes responsibility for controlling all Sporting, Technical, Financial and Calendar matters and must guarantee prize money as published.

## Appendix 2 Insurance and Motor Competitions

### 11.

(c) If special exposures to risks not covered in the standard Motorsport UK liability insurance exist such as in (b) above then full details should be made available to Jardine Lloyd Thompson in good time for them to respond on the nature of the cover required and its costs.

### 11.

(c) If special exposures to risks not covered in the standard Motorsport UK liability insurance exist such as in (b) above then full details should be made available to Bluefin Sport in good time for them to respond on the nature of the cover required and its costs.

**17.** In addition to covering officials Motorsport UK has arranged automatic cover for all Competition Licence holders. This personal accident insurance cover is valid from the date of issue of the competition licence or the First of January of the relevant licence year, whichever is the later. It is operative during any competition and/or official practice session at an event run under a permit issued by Motorsport UK or for which a Certificate of Exemption has been issued or run in accordance with the International Sporting Code of the FIA, under the authority of an FIA recognised ASN.

**17.** In addition to covering officials Motorsport UK has arranged automatic cover for all Competition Licence holders. This personal accident insurance cover is valid from the date of issue of the competition licence or the First of January of the relevant licence year, whichever is the later. It is operative during any competition and/or official practice session at an event run under a permit issued by Motorsport UK or for which a Certificate of Exemption has been issued or run in accordance with the International Sporting Code of the FIA, under the authority of an FIA recognised ASN.

**This additional personal accident cover applies to all competitors including those holding only a 'Club Card'.**

~~This additional personal accident cover applies to all competitors including those holding only a 'Club Card'.~~

## Appendix 5d Appointed Technical Commissioners

N/A

**McDonald, R J** Riverside, 2 School Green,  
Lasswade, Midlothian, EH18 1NB  
☎ (h): 0131 6638782 ☎ (m): 07774 692679  
Email: rabjmcdonald@gmail.com

## Officiel d'Honneur Appointments – Pages 14, 167 & 378

### Officiel d'Honneur Appointments

The following have accepted the position of Officiel d'Honneur for 2020:

<i>M F L Allison</i>	<i>A Dean-Lewis</i>
<i>G H Bailey</i>	<i>R McCabe</i>
<i>W Beattie</i>	<i>N S Manser</i>
<i>I D Bennie</i>	<i>P J Smith</i>
<i>K N Blackburn</i>	<i>Dr D B Stevens MBE</i>
<i>G S B Blythe</i>	<i>J B H Wood</i>
<i>H T Chapell</i>	<i>B Wright</i>
<i>T J Hassall</i>	

### Officiel d'Honneur Appointments

The following have accepted the position of Officiel d'Honneur for 2020:

<i>M F L Allison</i>	<i>A Dean-Lewis MBE</i>
<i>G H Bailey</i>	<i>R McCabe</i>
<i>W Beattie</i>	<i>N S Manser</i>
<i>I D Bennie</i>	<i>P J Smith</i>
<i>K N Blackburn</i>	<i>Dr D B Stevens MBE</i>
<i>G S B Blythe</i>	<i>J B H Wood</i>
<i>H T Chapell</i>	<i>B Wright</i>
<i>T J Hassall</i>	

## Section H Licences – Chart 7

Discipline	Driver	Navigator	Front Passenger	Rear Passenger	Remarks
<b>RACE</b>					
Car Race	16				14 Junior Race Formulae only
Truck Race	21				21 min age on road
Kart Race L/C	16				210cc max to 17
Kart Race S/C	8				85cc gearbox from 13
Kart Tyro	11				
Kart Endurance	16				15hp per Kart
Kart Bambino	6				Special Conditions
<b>RALLY</b>					
Road Rally	17+RTA	12		2	2-12 in a Child Seat
Navigation Rally	17+RTA	12		2	2-12 in a Child Seat
Stage Rally	17+RTA	16			14 Junior Rally Championship only 14 Single Venue Navigator
<b>TRIALS</b>					
Car Trial	14		12	2	2-12 in a Child Seat
Classic Reliability Trial	17+RTA		14	2	2-12 in a Child Seat
Sporting Trial	16		14		
<b>AUTOTEST</b>					
Autotest	16				14 up to 2000cc inc forced induction
PC Autotest	14		12		
<b>CROSS COUNTRY</b>					
Hill Rally	17+RTA	16			
Safari	17+RTA	16			
Cross Country Tyro	13		12	2	2-12 in a Child Seat
Cross Country Trial	17		14		Junior Trials from 8-17
<b>SPEED</b>					
Sprint and Hillclimb	16				
Minicross	14				
Autocross	16				14 Junior Autocross
Clubcross	14				
Rallycross	16				14 Junior Rallycross
Drag Race	16				Junior Dragsters from 8

Discipline	Driver	Navigator	Front Passenger	Rear Passenger	Remarks
<b>RACE</b>					
Car Race	16				14 Junior Race Formulae only
Truck Race	21				21 min age on road
Kart Race L/C	16				210cc max to 17
Kart Race S/C	8				85cc gearbox from 13 . U15.1.1
Kart Tyro	11				
Kart Endurance	16				17hp per Kart
Kart Bambino	6				Special Conditions
<b>RALLY</b>					
Road Rally *	17+RTA	12		2	2-12 in a Child Seat
Navigation Rally *	17+RTA	12		2	2-12 in a Child Seat
Stage Rally	17+RTA	16			14 Junior Rally Championship only 14 Single Venue Navigator
<b>TRIALS</b>					
Car Trial **	14		12	2	2-12 in a Child Seat
Classic Reliability Trial **	17+RTA		14	2	2-12 in a Child Seat
Sporting Trial **	16		14		
<b>AUTOTEST</b>					
Autotest	16				14 up to 2000cc inc forced induction
PC Autotest/Autosolo ***	14		12		
<b>CROSS COUNTRY</b>					
Hill Rally ***	17+RTA	16			
Safari ***	17+RTA		16		
Cross Country Tyro **	13		12	2	2-12 in a Child Seat
Cross Country Trial ***	17		14		Junior Trials from 8-17
<b>SPEED</b>					
Sprint and Hillclimb	16				
Minicross	14				
Autocross	16				14 Junior Autocross
Clubcross	14				
Rallycross	16				14 Junior Rallycross
Drag Race	16				Junior Dragsters from 8

Passengers are ONLY permitted in events indicated by \*, \*\* and \*\*\*

\* Rear passengers do NOT need a licence if under 18

\*\* Rear and front passengers do NOT need a licence if under 18

\*\*\* Driver and front passenger(s) need licences

## Section H Licences – Chart 26

Chart 26: Competitors Minimum Acceptable Licences

MOTOR SPORT DISCIPLINE	EVENT STATUS (as defined in Supplementary Regulations)			
	CLUBMAN	INTERCLUB	NATIONAL	INTERNATIONAL
AUTOTESTS	RS Clubman	Any Interclub		
ALL TRIALS	RS Clubman	Any Interclub		
NAVIGATION RALLY	RS Clubman	Any Interclub	Any National	
ROAD RALLY (including Targa, Historic and Endurance)	RS Clubman	Any Interclub	Any National	
SAFARIS, TIME TRIALS, TEAM RECOVERIES, CHALLENGE EVENTS	RS Clubman	Any Interclub	Any National	Cross Country 'R' or Stage Rally International 'R'
HILL RALLIES	RS Clubman (6)	Any Interclub	RS National (5)	Cross Country 'R' or Stage Rally International 'R'
CLUBCROSS	RS Clubman			
AUTOCROSS (including MINICROSS)	RS Clubman	Any Interclub		
HILL CLIMBS, SPRINTS		Any Interclub (6)	RS National or Race National (6)	Speed 'R' or Race 'C' International
DRAG RACES		Any Interclub	RS National – Drag Endorsement	Drag International
RALLYCROSS		Any Interclub	RS National or Race National	Off-Road International 'C' Race International
STAGE RALLIES		RS Interclub – Stage Rally (4)	RS National – Stage Rally (5)	Rally International 'R'
STAGE RALLIES (HISTORIC)		RS National – Stage Rally	RS National – Stage Rally	Rally International 'R' or Rally International 'H'
KART ENDURANCE	Kart Clubman (7)			
KART TYRO	Kart Clubman (7)			
KART BAMBINO	Kart Clubman Bambino (9)			
RACE		Race Interclub	Race National	Race International (10)
RACE HISTORIC		Race Interclub	Race National	Race International (10)
RACE KART (11)		Kart Interclub or Race Interclub	Kart National or Race National	Kart International
RACE TRUCK		Race National – Truck Endorsement	Race National – Truck Endorsement	International Truck 'C'

**NB**  
 (1) A higher grade licence is always valid for lower permit events of the same discipline (exceptions see 8 below).  
 (2) Race licences are valid for speed events.  
 (3) Race<sup>10</sup>, RS and RS Stage Rally licences are valid for Rallycross.  
 (4) Any Interclub, RS National, Race National, RS Rally National Navigator and any International Licence is valid for Stage Navigator.  
 (5) RS Rally National Navigator is valid for Stage Navigator.  
 (6) RS National or Race National required for vehicles defined in S7.1 of the Regulations.  
 (7) Kart Clubman Licence is only valid for Kart Endurance/Kart Tyro events.  
 (8) Race National Licences also valid for Long Circuit Kart events.  
 (9) A Kart Bambino event may accept any competitor until the 31st December in the year of their 8th birthday.  
 (10) Weight to power ratios have been imposed by FIA according to licence status. Unless otherwise stated reference to International Race requires a minimum licence status of International 'C' Race.  
 (11) For Long Circuit Kart events either the endorsed "valid for Long Circuit" Kart Licence or Race Licence, as specified above, is acceptable.

Chart 26: Competitors Minimum Acceptable Licences

MOTOR SPORT DISCIPLINE	EVENT STATUS (as defined in Supplementary Regulations)			
	CLUBMAN	INTERCLUB	NATIONAL	INTERNATIONAL
AUTOTESTS	RS Clubman	Any Interclub		
ALL TRIALS	RS Clubman	Any Interclub		
NAVIGATION RALLY	RS Clubman	Any Interclub	Any National	
ROAD RALLY (including Targa, Historic and Endurance)	RS Clubman	Any Interclub	Any National	
SAFARIS, TIME TRIALS, TEAM RECOVERIES, CHALLENGE EVENTS	RS Clubman	Any Interclub	Any National	Cross Country 'R' or Stage Rally International 'R'
HILL RALLIES	RS Clubman	Any Interclub	RS National (5)	Cross Country 'R' or Stage Rally International 'R'
CLUBCROSS	RS Clubman			
AUTOCROSS (including MINICROSS)	RS Clubman	Any Interclub		
HILL CLIMBS, SPRINTS		Any Interclub (6)	RS National or Race National (6)	Speed 'R' or Race 'C' International
DRAG RACES		Any Interclub	RS National – Drag Endorsement	Drag International
RALLYCROSS		Any Interclub	RS National or Race National	Off-Road International 'C' Race International
STAGE RALLIES		RS Interclub – Stage Rally (4)	RS National – Stage Rally (5)	Rally International 'R'
STAGE RALLIES (HISTORIC)		RS Interclub – Stage Rally	RS National – Stage Rally	Rally International 'R' or Rally International 'H'
KART ENDURANCE	Kart Clubman (7)			
KART TYRO	Kart Clubman (7)			
KART BAMBINO	Kart Clubman Bambino (9)			
RACE		Race Interclub	Race National	Race International (10)
RACE HISTORIC		Race Interclub	Race National	Race International (10)
RACE KART (11)		Kart Interclub or Race Interclub	Kart National or Race National	Kart International
RACE TRUCK		Race National – Truck Endorsement	Race National – Truck Endorsement	International Truck 'C'

**NB**  
 (1) A higher grade licence is always valid for lower permit events of the same discipline (exceptions see 8 below).  
 (2) Race licences are valid for speed events.  
 (3) Race<sup>10</sup>, RS and RS Stage Rally licences are valid for Rallycross.  
 (4) Any Interclub, RS National, Race National, RS Rally National Navigator and any International Licence is valid for Stage Navigator.  
 (5) RS Rally National Navigator is valid for Stage Navigator.  
 (6) RS National or Race National required for vehicles defined in S7.1 of the Regulations.  
 (7) Kart Clubman Licence is only valid for Kart Endurance/Kart Tyro events.  
 (8) Race National Licences also valid for Long Circuit Kart events.  
 (9) A Kart Bambino event may accept any competitor until the 31st December in the year of their 8th birthday.  
 (10) Weight to power ratios have been imposed by FIA according to licence status. Unless otherwise stated reference to International Race requires a minimum licence status of International 'C' Race.  
 (11) For Long Circuit Kart events either the endorsed "valid for Long Circuit" Kart Licence or Race Licence, as specified above, is acceptable.



## Section R Rallying – Drawing Number 29.1

Alternative to Drawing number 29 without the use of box junctions

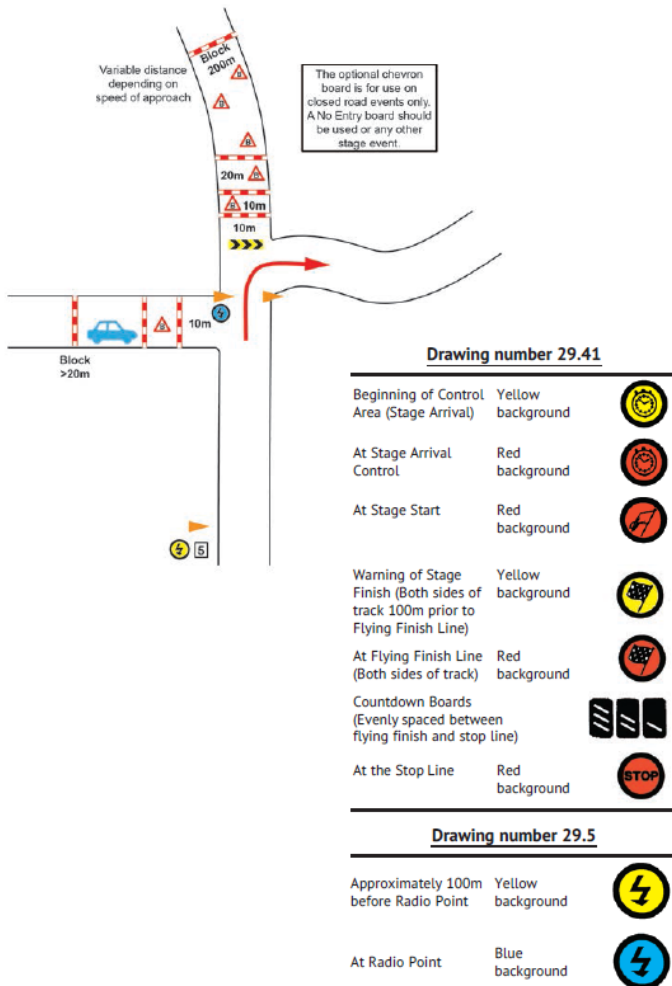

Alternative to Drawing number 29 without the use of box junctions

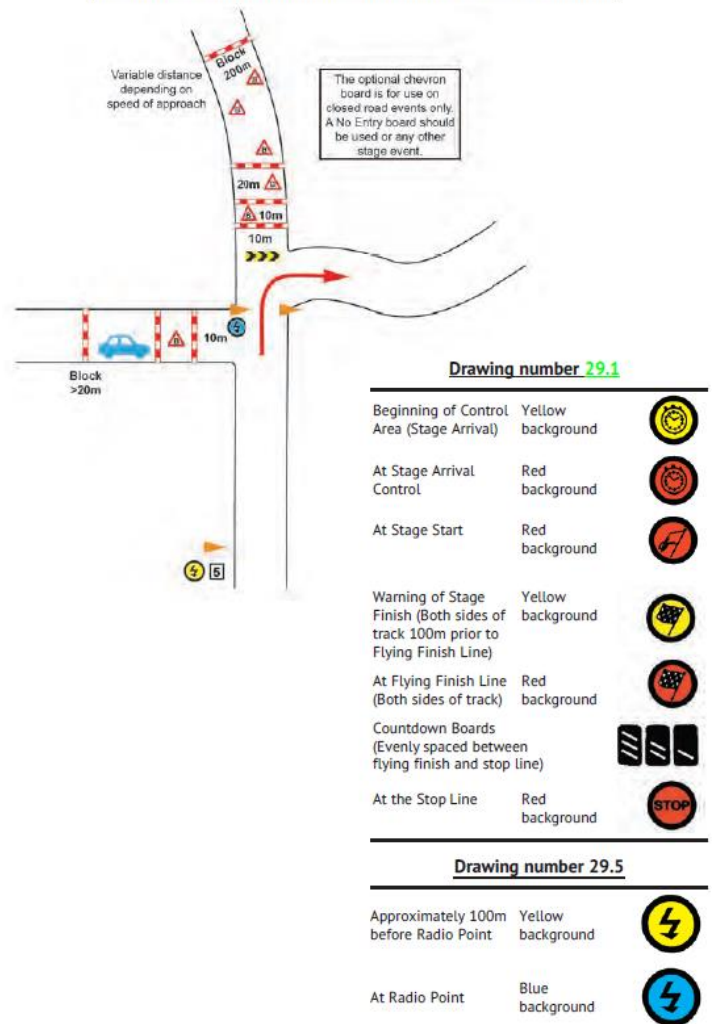

## Section U Karting

21.1.2. Any permitted appeal to the Stewards of the Meeting, from decisions in the final(s), will not be eligible for further appeal to the National Court.

21.1.2. In respect of the final(s), the Stewards of the Meeting may hear a validly lodged appeal where permitted against sporting matters determined by the Clerk of the Course. However there is no right of appeal to the National Court against any sporting decision of the Stewards of the Meeting OR against any eligibility Decision.

## Section B Nomenclature and Definitions

**Organising Club.** competing in Rallies, or other events, held entirely on the public highway.

**Organising Club.** A club registered with Motorsport UK and responsible in all respects for the organisation of an event.

## REGULATION CHANGES APPROVED BY MOTORSPORT UK BOARD – DECEMBER 2019

### Section H Licences

**16.1.1.** A competitor who held an International, National or National 'A' Speed licence before 31.12.02 may renew it for a lower grade of licence or an RS National in 2020.

**19.2.2.** A Competitor who is qualified to hold a Kart Interclub licence may upgrade it to a Kart National licence either at renewal or during the year as follows:  
Obtain the Motorsport UK Steward's signature on the Upgrade Card at six Clubman or Interclub Kart Races. Three of these signatures may have been obtained at NatSKA or Kart Tyro meetings held under a Motorsport UK Permit. Completion of the ARKS Course (8.3) will constitute one of

the six signatures. Signatures must have been obtained at a minimum of three different venues. For competitors in Long Circuit events only two different venues are required so long as the application is supported by a Long Circuit Karting organising Club. For upgrades containing both Short and Long Circuit signatures the minimum of three different venues is required.

**12.1.9.** Postal applicants for an RS Clubmans Licence who answer yes to either of the following questions;

- Do you have any serious medical condition which affects your ability to drive and control a car?
- Are you epileptic or do you suffer from any fits, fainting spells or blackouts or take any medication to control this?

may be issued with a Competition Licence endorsed Non-Driver to allow participation as a passenger or navigator.

**12.1.10.** For events other than those Cross Country events included within P25.1. passengers applying for an RS Clubmans Licence on the day who answer yes to either of the following:

- Do you have any serious medical condition which affects your ability to drive and control a car?
- Are you epileptic or do you suffer from any fits, fainting spells or blackouts or take any medication to control this?

may participate on the day, subject to 12.1.8. as a passenger or navigator and may be issued with their Competition Licence endorsed Non-Driver.

**16.1.1.** A competitor who has ever held a Speed International, Speed National, Speed National 'A' or Speed National 'A' (OPEN) licence- may renew it for the equivalent or a lower grade of licence in 2020.

**19.2.2.** A Competitor who is qualified to hold a Kart Interclub licence may upgrade it to a Kart National licence either at renewal or during the year as follows:  
Obtain the Motorsport UK Steward's signature on the Upgrade Card at six Clubman (prior to 31.12.2019) or Interclub Kart Races. One of these signatures may have been obtained at NatSKA or Kart Tyro meetings held under a Motorsport UK Permit. Completion of the ARKS Course

(8.3) will constitute one of the six signatures. Signatures must have been obtained at a minimum of three different venues. For competitors in Long Circuit events only two different venues are required so long as the application is supported by a Long Circuit Karting organising Club. For upgrades containing both Short and Long Circuit signatures the minimum of three different venues is required. A competitor may only obtain one signature per meeting.

**19.2.4.** A competitor must be eligible for a National licence in order to apply for an International 'C' licence. An International 'C' Junior licence can be issued to drivers between their 12th birthday (reaching their 12th birthday during the calendar year) and under 14 years of age when the Licence is issued. An International 'C' Restricted can be issued to drivers between their 14th birthday (reaching their 14th birthday during the calendar year) and under 15 years of age when the Licence issued. An International 'C' Senior licence can be issued to drivers reaching their 15th birthday during the calendar year. Application must be made in accordance with the Regulations published in the 2020 CIK Annuaire.

## Section L Permitted Tyres

### LIST 3

#### Tyres for Sporting Car Trials

##### MAXXIS

- MA-510N

##### NANKANG

- CX668

##### VREDESTEIN

- T-Trac 2

## Section P Cross Country Events

**21.2.1.** Deleted.

A competitor may only obtain one signature per meeting.

**19.2.4.** A competitor who is qualified to hold a National licence may upgrade it to an International 'C' licence either at renewal or during the year as follows:

Obtain the Clerk of the Course or Motorsport UK Steward's signature (G2.4.13 and 5.2.19 applies) on the Upgrade Card at six Interclub or 3 national Kart Races. An International 'C' Junior licence can be issued to drivers between their 12th birthday (reaching their 12th birthday during the calendar year) and under 14 years of age when the Licence is issued. An International 'C' Restricted can be issued to drivers between their 14th birthday (reaching their 14th birthday during the calendar year) and under 15 years of age when the Licence issued. An International 'C' Senior licence can be issued to drivers reaching their 15th birthday during the calendar year. Application must be made in accordance with the Regulations published in the 2020 CIK Annuaire.

### LIST 3

#### Tyres for Sporting Car Trials

##### MAXXIS

- MA-510N
- ME-3

##### NANKANG

- CX668
- NA-1

##### TOYO

- 330

##### VREDESTEIN

- T-Trac 2

**21.2.1.** For any Cross Country event where Crash Helmets are required and irrespective of licence grade, drivers, navigators and passengers who have any notifiable

condition included within H10.1.9. may not apply for their competition licence on the day and should allow a calendar month for their application to be assessed and processed.

## Section R Rallying

**5.2.1.** Both Driver and Co-Driver or Navigator must hold and produce a valid Competition Licence for those rallies specified in the 2020 Chart of Minimum Acceptable Licences as requiring a Competition Licence.

## Section U Karting

**14.1.2.** A competitor will be considered as a 'Novice' and must use Novice number plates (17.27.4), for Long Circuits Q.11.3. applies, until he has obtained six kart race signatures from Motorsport UK Stewards. (Completion of the ARKS Course (H.8.3) will constitute one of the six signatures.) Three of these signatures may have been obtained at NatSKA meetings held under a Motorsport UK Permit. Thereafter he can continue to compete on a National 'B' Novice) Licence, or can upgrade to a National 'B' Licence in accordance with H.19.2 but he will no longer be considered a novice.

**21.1.2.** Any permitted appeal to the Stewards of the Meeting, from decisions in the final(s), will not be eligible for further appeal to the National Court.

**5.2.1.** Both Driver and Co-Driver or Navigator must hold and produce a valid Competition Licence for those rallies specified in the 2020 Chart of Minimum Acceptable Licences as requiring a Competition Licence. Exceptionally and for Clubmans Historic Road Rallies only, competitors who are not eligible to apply for a UK Competition Licence may obtain a Historic Regularity Competitors Permit which use and validity is limited solely to that rally.

**14.1.2.** A competitor will be considered as a 'Novice' and must use Novice number plates (17.27.4), for Long Circuits Q.11.3. applies, until he has obtained six kart race signatures from Motorsport UK Stewards. (Completion of the ARKS Course (H.8.3) will constitute one of the six signatures.) One of these signatures may have been obtained at a NatSKA meeting held under a Motorsport UK Permit. Thereafter he can continue to compete on an Interclub Licence, or can upgrade to a National Licence in accordance with H.19.2 but he will no longer be considered a novice.

**21.1.2.** In respect of the final(s), the Stewards of the Meeting may hear a validly lodged appeal where permitted against sporting matters determined by the Clerk of the Course. However there is no right of appeal to the National Court against any sporting decision of the Stewards of the Meeting OR against any eligibility Decision.